

DO NOT SCALE FROM THIS DRAWING. USE FIGURED DIMENSIONS IN ALL CASES. VERIFY DIMENSIONS ON SITE AND REPORT ANY DISCREPANCIES TO THE ARCHITECTS IMMEDIATELY. THIS DRAWING IS TO BE READ IN CONJUNCTION WITH THE ARCHITECTS SPECIFICATION. © THIS DRAWING IS COPYRIGHT AND MAY ONLY BE REPRODUCED WITH THE ARCHITECTS PERMISSION.

| REV | DATE | DRN | ISSUE |
|-----|------------|----------|-----------------------------------|
| P02 | 21.03.2024 | GK | Reviewed for Planning Application |
| P01 | 03.11.2023 | A.Olalla | Issued for Planning |

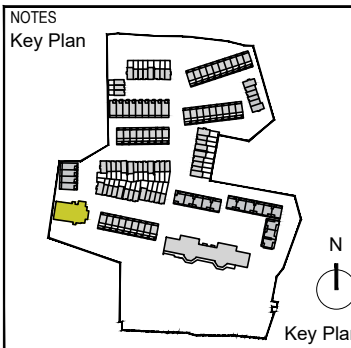

- Legend:
- ① External envelope of exiting structure will be conserved in accordance with best practice involving necessary repairs to the existing slate roof where required
 - ② Inspection and repair where required of lead and stone weathering details
 - ③ Conservation of wall masonry including localised re-pointing of lime mortar joints where needed
 - ④ Conservation of existing windows and external doors.

Please refer to John Cronin & Associates Built Heritage Appraisal report to be read in conjunction with this drawing.

| PLANNING | |
|---|--------------------|
| JOB St. Kevin's Residential Development At the former St. Kevin's Hospital and Grounds Shanakiel, Cork | |
| CLIENT Land Development Agency | |
| DRAWING Roof Plan and Sections Proposed Chapel Conversion to Creche | |
| DATE 03.11.2023 | SCALE 1:200 @ A3 |
| DRN. A.Olalla | CHECKED P.Mulligan |

Reddy Architecture + Urbanism
Cork Office,
Douglas Business Centre, Carrigaline Road, Douglas, Co. Cork

T: +353 (0)21 4362922
W: www.reddyarchitecture.com
E: cork@reddyarchitecture.com

DWG NO. SKC-RAU-CHZZ-DR-A-1708 REVISION P02